

FM SERIES

HIGH PRESSURE, 316 STAINLESS STEEL, FLAT FACE COUPLINGS.

INTRODUCTION

FM Series couplings are produced in stainless steel for use in normal hydraulic applications and offshore installations involving salty, corrosive environments. They are suitable for continuous submersion in sea water. However, they should not be used in applications that involve intermittent submersion in sea water unless there is a rigorous programme of drying and lubricating the couplings after each submersion.

Benefits of these couplings include 'no fluid spillage on disconnection' and easily wiped clean mating faces to help prevent the ingress of contaminants.

ADVANTAGES

- ★ Flat faces can easily be wiped clean before connection to prevent the ingress of contaminants into the circuit.
- ★ Clean disconnection - non-spill design.
- ★ No air intrusion during connection.
- ★ Streamlined flow path minimises pressure drop.
- ★ Locking sleeve prevents accidental disconnection.
- ★ Bi-directional flow.
- ★ Suitable for use at depths of 1000 m when connected.
- ★ Made to ISO 16028 connection sizes.

MATERIALS

Body and structural components - AISI 316

Spring guide in male coupling - brass

Springs - AISI 302

Locking balls - AISI 316

Internal oil seals - Viton

External water seals - Neoprene

Other seal materials available on request.

PRESSURE RATINGS

Type and size	Maximum working pressure coupled (bar)	Burst pressure coupled (bar)	Burst pressure female (bar)	Burst pressure female with plug (bar)	Burst pressure male (bar)	Burst pressure male with cap (bar)
FM 7	350	1700	600	1700	1450	1700
FM 9	350	1500	800	1500	1500	1700
FM 13	350	1450	750	1450	1000	1450
FM 15	350	1250	500	1250	950	1250
FM 17	350	1150	600	1000	800	1150
FM 21	300	850	500	850	800	850
FM 27	250	700	400	700	700	700



PRESSURE DROP CHARACTERISTICS

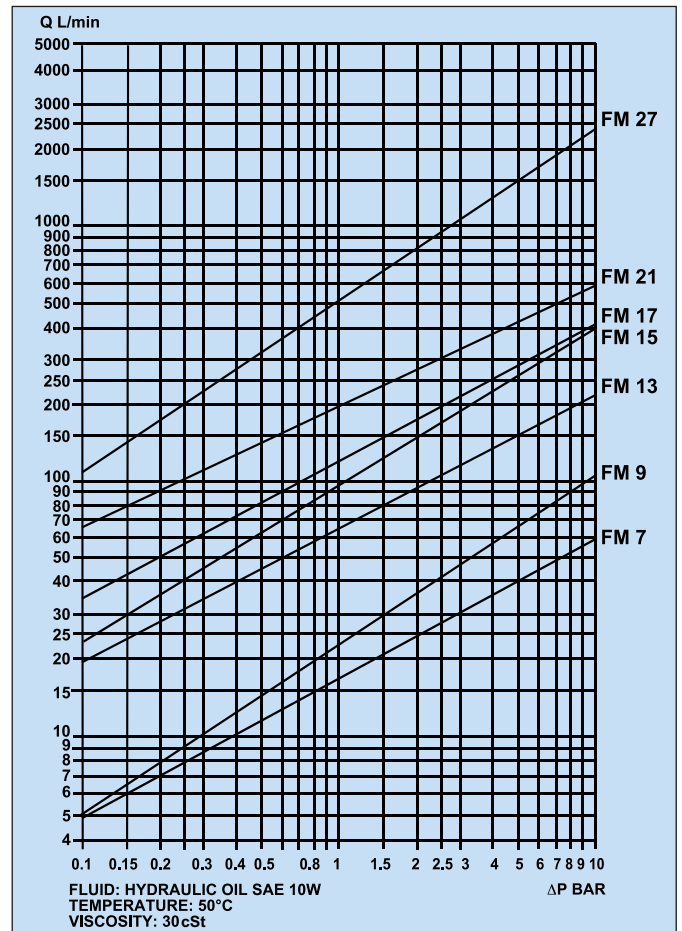

FM SERIES COUPLINGS

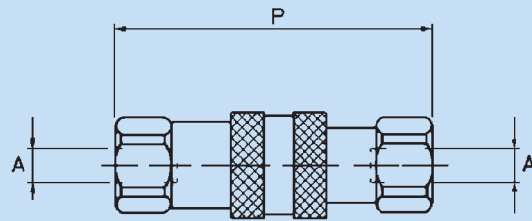

Female and Male Coupled

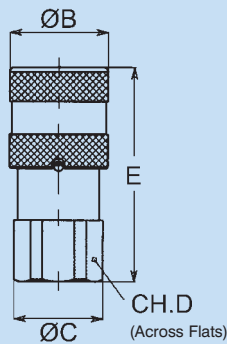

Female

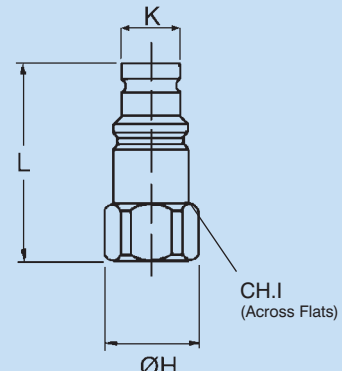

Male

Type and Size	A*	ØB	ØC	CH D	E	ØH	CH I	K	L	P
FM 7	1/4"	28	24	22	48.5	24	22	16.2	48	85.5
FM 9	3/8"	32	29	27	64	26	24	19.8	60	109
FM 9A	1/2"	32	29	27	69	29	27	19.8	62.5	116.5
FM 13	1/2"	38	34	32	74	34	32	24.5	68	125
FM 13	3/4"	38	38.5	36	81	38.5	36	24.5	70.5	134.5
FM 15	3/4"	42	38.5	36	78	38.5	36	27	70.5	132
FM17	1"	48	48	45	93	48	45	30	82.5	154
FM 21	1 1/4"	55	60	55	106	60	55	36	90	173
FM 27	1 1/2"	80	72	65	132	76	70	57	111	215

ORDER CODES

* FM * ** ***

M = Male
F = Female

Type and size

Thread dimension 'A'
see table above

Thread: BSP, NPT or SAE

DUST CAPS - SEE PAGE 52

